



Proposed raised carriageway table with footway buildouts at junction with Abbeyfield Road to improve crossing conditions and safety for pedestrians

Proposed landscaping with tree and shrub planting

Large footway buildout to reduce carriageway width and crossing distance for pedestrians

Footway to be extended on the northern side of the roundabout to improve the pedestrian environment and create space past mature trees that currently block the existing footway

Southern side of roundabout to be trimmed to allow for extension of footways. Existing trees and garden beds will remain

Proposed raised zebra crossing with footway buildouts to reduce carriageway width, reduce traffic speeds and improve pedestrian accessibility

Footway buildout on eastern side of roundabout to improve the pedestrian environment

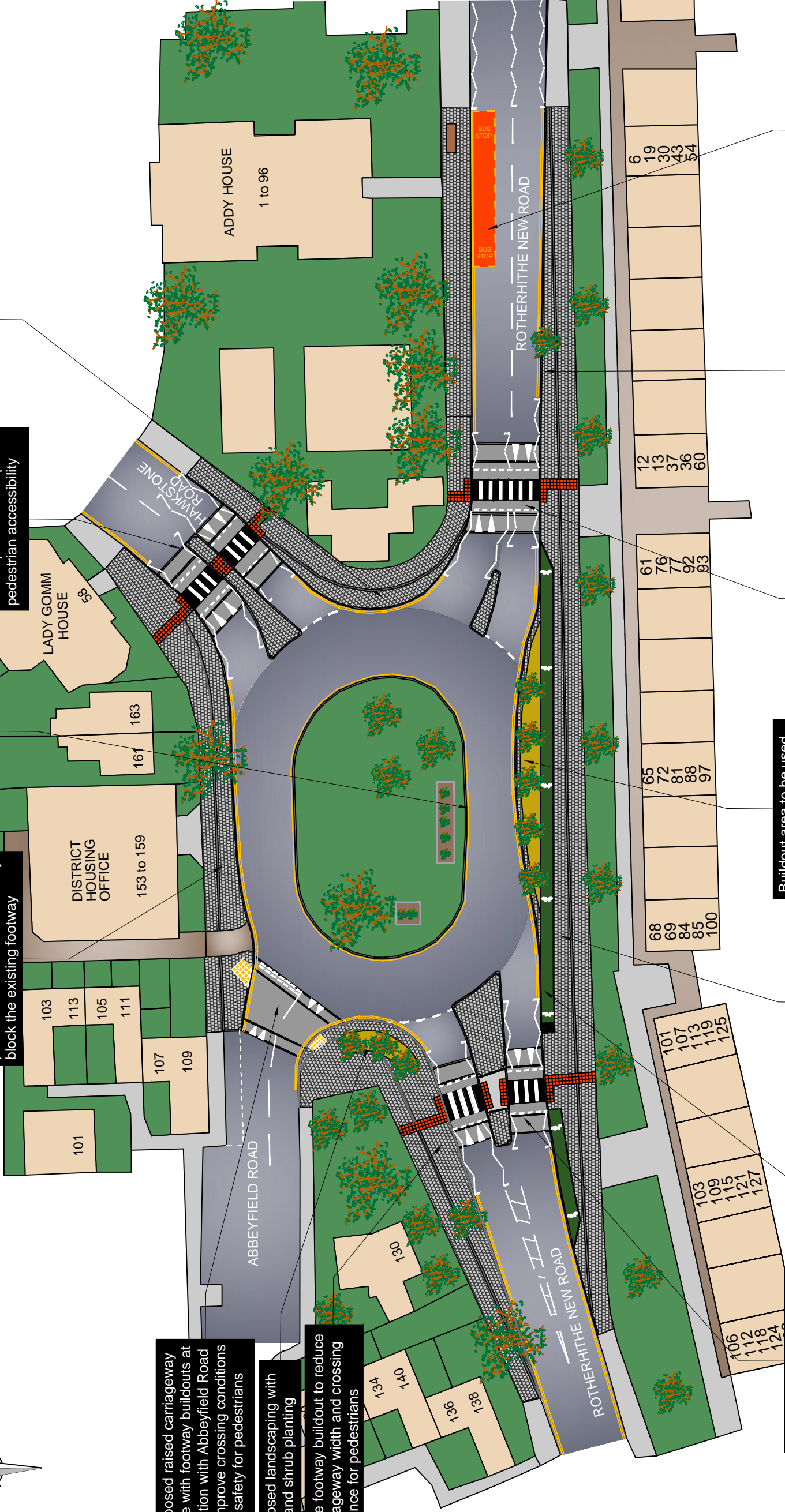

Proposed raised zebra crossing with footway buildouts to reduce carriageway width, reduce traffic speeds and improve pedestrian accessibility

Proposed cycle lane to allow pedal cyclists to bypass the roundabout

Large footway buildout to improve the pedestrian environment and to narrow carriageway width

Buildout area to be used for tree and shrub planting to improve the streetscape and to create more deflection on approach to the roundabout (reducing vehicle entry speeds)

Proposed raised zebra crossing on eastern arm of Rotherhithe New Road to improve pedestrian safety and accessibility

Footway to be built out to reduce carriageway width on approach to zebra crossing. Built out area will have tree planting

Bus stop to be relocated towards existing pelican crossing to allow room for the installation of the new zebra crossing near the roundabout